



**Plumbing**  
Contest Update from Chair

**Contest Chair: Justin Wardle – Cloverdale Plumbing**  
[justin@cloverdaleplumbing.com](mailto:justin@cloverdaleplumbing.com)

**Competition Date: Thursday, March 5th, 2026**

**Location:**

CWI Nampa Caldwell BLVD Campus	Plumbing Lab Room 151	2407 Caldwell Blvd Nampa ID 83651
--------------------------------	--------------------------	--------------------------------------

**Orientation Time: 8:30 am**

Please arrive 10-15 minutes prior to orientation

**National Technical Standard Variations:**

National Technical Standards will be followed as closely as possible.

**Supplied by the technical committee:**

- All plumbing stations, materials, and platforms necessary for competition will be available for each competitor.

**Supplied by the competitor:**

**Tools Supplied by the competitor:**

- Steel tape measure and/or folding rule
- Copper tubing cutter with reamer
- Arc joint pliers (channel lock type)
- An adjustable wrench
- Set of assorted slotted and Phillips screwdrivers
- Torpedo level
- 14-16 oz. claw hammer
- Plastic (PVC) pipe reamer or suitable knife
- Any one of the following: Manual saw, plastic pipe shear, battery operated reciprocating saw, pipe cutter with plastic cutter-wheel capable of cutting up to 3" PVC pipe.



- Copper cleaning tool (inside and outside)
- Pencil and eraser
- Black permanent marker (Sharpie fine point)
- 5/16" nut driver
- Hacksaw, manual or battery operated.
- Portable battery-operated screw gun
- Assorted screwdriver tips and 5/16" nut driver end for use with battery operated screw gun.
- Plumb bob
- Speed square
- Wiping rag
- Work gloves (optional)

**Schedule for Event**

<b>Time</b>	<b>Item</b>	<b>Item Description</b>
8:30 a.m.	Welcome/Orientation	Welcome competitors to the competition and go through a brief review of the competition.
9:00 a.m.	Competition Begins	Competitors are given competition drawings.
12:00 p.m. – 12:30 pm	Lunch	
2:30 p.m.	End of Competition	All
3:00 p.m. - 4:00 p.m.	Deconstruct competition and cleanup.	Deconstruct competition materials and throw them in the dumpster. Sweep the competition area.



### Sample Score Card

**Contest: Plumbing**

Type	Skills Area	Max Score
Standard	Knowledge Test	50
Standard	Oral Professional Assessment	20
Standard	Copper Piping Installation & Accuracy	230
Standard	PVC Piping Installation & Accuracy	230
Standard	Fixture Installation & Completion (Lav. Only)	180
Standard	Safety-Tools-Attire - Use and Care	35
Standard	SkillsUSA Professional Development Test	25
Tie Breaker	Pressure Test	1
Tie Breaker	Material Take-off	1
Penalty	Clothing Penalty	-10
Penalty	Resume Penalty	-10
Penalty	Extra Materials	-50
Penalty	Work Ethics	-50
<b>TOTAL</b>		<b>770</b>

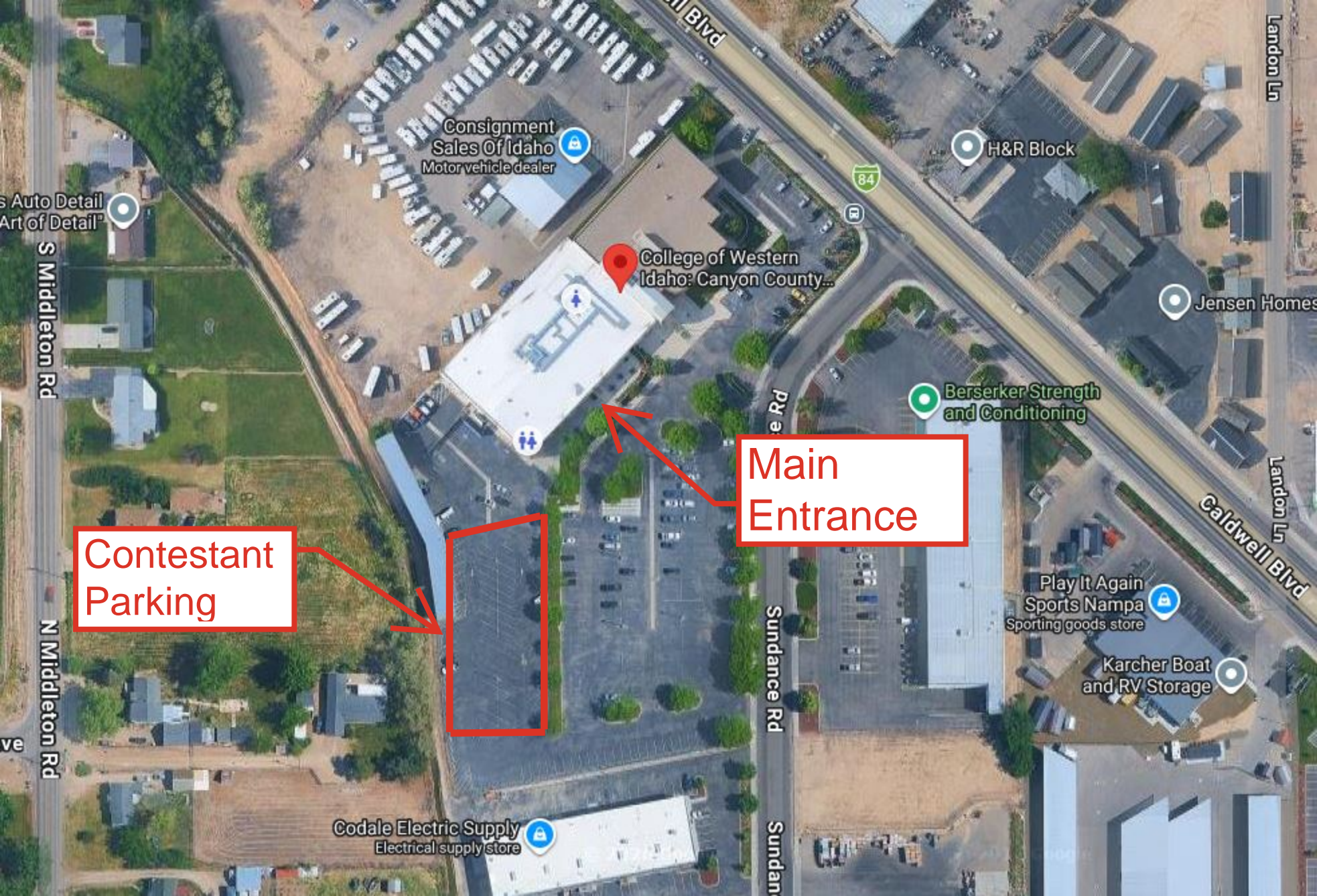

Main Entrance

Contestant Parking

College of Western Idaho: Canyon County...

Consignment Sales Of Idaho Motor vehicle dealer

H&R Block

Berserker Strength and Conditioning

Play It Again Sports Nampa Sporting goods store

Karcher Boat and RV Storage

Codale Electric Supply Electrical supply store

S Middleton Rd

N Middleton Rd

Sundance Rd

Sundan

Landon Ln

Landon Ln

Caldwell Blvd

Competition Area  
Room 151

Competitor Check-In

Restrooms

Main Entrance

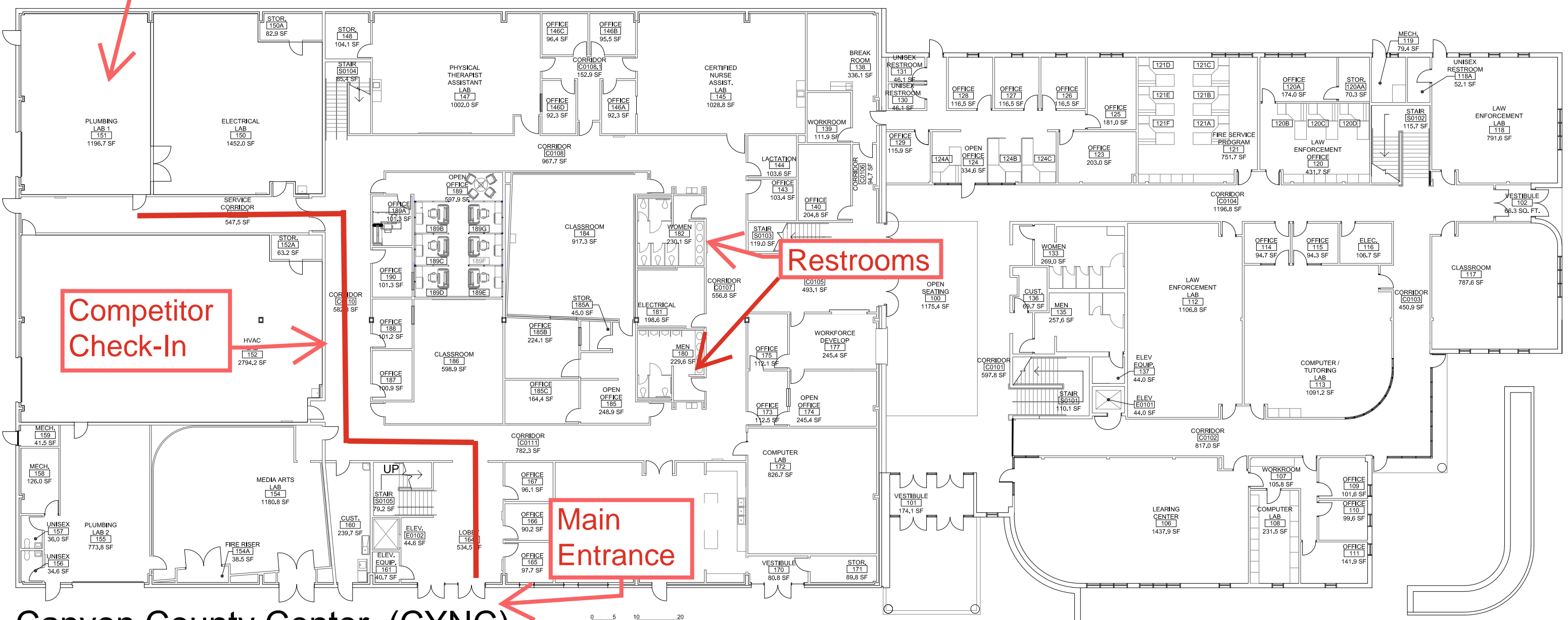

**Canyon County Center (CYNC)**  
FIRST FLOOR  
2407 Caldwell Boulevard, Nampa, ID 83651

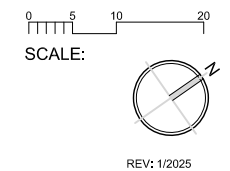

REV: 1/2025